

**DOWNLOAD THE MSS APP**  
FOR THE MOST UPDATED  
MEETING INFORMATION!



Download on your iPhone.



Download on your Android.



#MidwestSoc

Midwest Sociological Society  
6001 Dodge Street, ASH 383  
Omaha, NE 68182  
www.themss.org

## BEFORE AND AFTER: REMEMBERING THE PAST AND ENVISIONING THE FUTURE

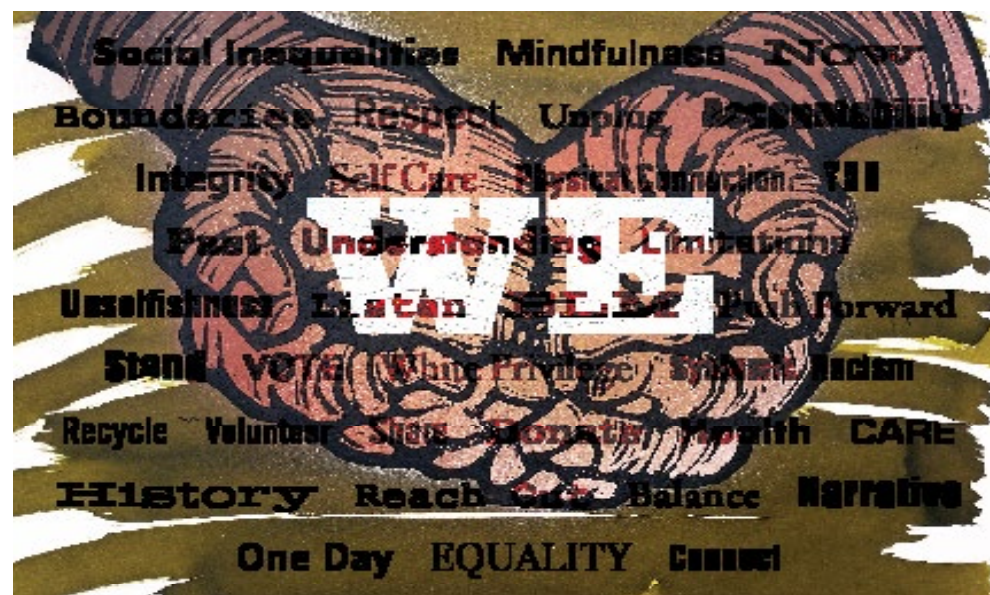

Elevators and escalators are found throughout the meeting space for your convenience. Rooms on our program are noted on the map in bold. There are many levels, but access to all should be easy by way of elevators and escalators.

A Lactation Room and all gender restrooms can be found on the 2nd floor of the Event Centre, near the meeting rooms.

Access to the Pedway is on the Concourse Level, one floor above the Lucerne Level. The UPS business center is also on the Concourse level, near the Pedway entrance.

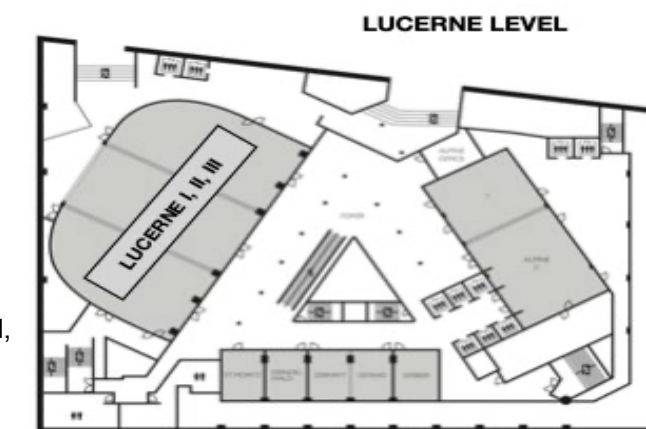

EVENT CENTRE - 1

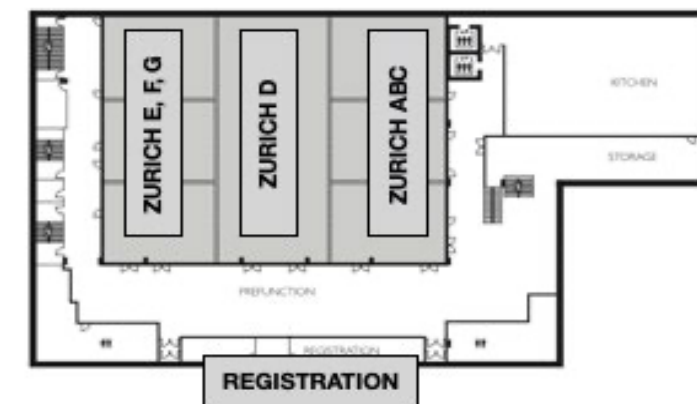

EVENT CENTRE - 2

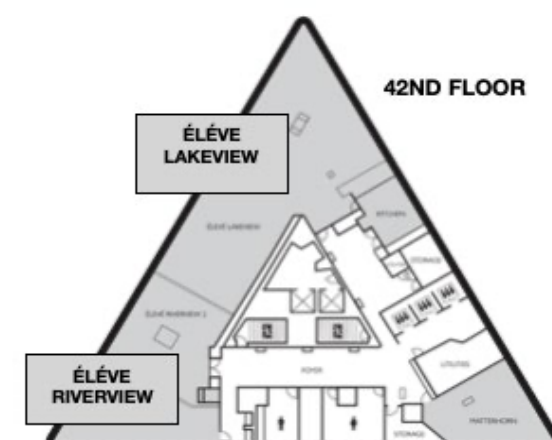
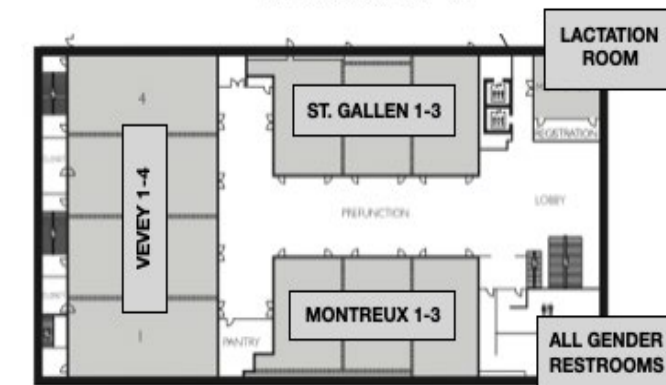

April 13-16, 2022

MSS Annual Meeting  
Swissotel Chicago  
Chicago, Illinois

## 2022 ANNUAL MEETING PROGRAM COMMITTEE

<b>Chair</b>	<b>Brian Donovan</b> , University of Kansas
<b>Student Director</b>	<b>Elyse Neumann</b> , University of Kansas
<b>MSS Executive Director</b>	<b>Jennifer Talarico</b>
<b>Meeting Systems Coordinator</b>	<b>Sadie Pendaz-Foster</b> , Inver Hills Community College
<b>Local Arrangements</b>	<b>Juan Martinez</b> , Northeastern Illinois University; <b>Kevin Lamar James</b> , University of Illinois Chicago
<b>Committee Members</b>	<b>Sarah Epplen</b> , Minnesota State University, Mankato <b>LaShaune Johnson</b> , Creighton University <b>Patrick McGinty</b> , Western Illinois University <b>Julie Pelton</b> , University of Nebraska Omaha <b>Sadie Pendaz-Foster</b> , Inver Hills Community College
<b>Volunteer Session Organizers</b>	<b>Abdallah Badahdah</b> , South Dakota State University <b>Kristi Brownfield</b> , Northern State University <b>Ryan Ceresola</b> , Hartwick College <b>Carrie Coward Bucher</b> , Elmhurst University <b>Patrick Fontane</b> , Professor Emeritus, University of Health Sciences & Pharmacy in St. Louis <b>Benjamin Hartmann</b> , Indiana University Bloomington <b>Aaron Hoy</b> , Minnesota State University, Mankato <b>Robert Jenkot</b> , Coastal Carolina University <b>Mary Ann Kanieski</b> , Saint Mary's College <b>Kevin McCannon</b> , University of Kansas <b>Emily Navarro</b> , Elmhurst University <b>Sadie Pendaz-Foster</b> , Inver Hills Community College <b>Fithawee Tzeggai</b> , University of Kansas <b>Doug Valentine</b> , Truman State University <b>Lisa Waldner</b> , University of St. Thomas

## 3MT Judges

**Pamela Emanuelson**, North Dakota State University  
**Sarah Frank**, University of Wisconsin-Madison  
**James Dalton Stevens**, Syracuse University



## 2021-22 MSS BOARD OF DIRECTORS

<b>President</b>	<b>Meredith Redlin</b> , South Dakota State University
<b>President-Elect / 2021 Program Chair</b>	<b>Brian Donovan</b> , University of Kansas
<b>Past President / ASA Representative</b>	<b>Julie Pelton</b> , University of Nebraska Omaha
<b>Secretary</b>	<b>Megan Nielsen</b> , Midland University
<b>Treasurer</b>	<b>Lisa Thrane</b> , Iowa State University
<b>At-large Director</b>	<b>Gina Petonito</b> , Write YOUR Way LLC
<b>At-large Director</b>	<b>Deniz Yucel</b> , William Paterson University of New Jersey
<b>Illinois Director</b>	<b>Jorge Chaves-Rojas</b> , Millikin University
<b>Iowa Director</b>	<b>Susan Stewart</b> , Iowa State University
<b>Kansas Director</b>	<b>Rochelle Rowley</b> , Emporia State University
<b>Minnesota Director</b>	<b>Lisa Waldner</b> , University of St. Thomas
<b>Missouri Director</b>	<b>Ahoo Tabatabai</b> , Columbia College
<b>Nebraska Director</b>	<b>Lisa Kort-Butler</b> , University of Nebraska-Lincoln
<b>Dakotas Director</b>	<b>Elizabeth Legerski</b> , University of North Dakota
<b>Wisconsin Director</b>	<b>Brandon Hofstedt</b> , University of Wisconsin-Madison
<b>Student Directors</b>	<b>Michael Miner</b> , Meta Research <b>Sana Illahe</b> , South Dakota State University <b>Elyse Neumann</b> , University of Kansas
<b>Chair, Publications Comm</b>	<b>Joan Hermsen</b> , University of Missouri
<b>Chair, Finance Comm</b>	<b>Pamela Emanuelson</b> , North Dakota State University
<b>Chair, Annual Meeting Comm</b>	<b>Patrick McGinty</b> , Western Illinois University
<b>Chair, Long Range Planning Comm</b>	<b>Peter Kivisto</b> , Augustana College
<b>MSS Executive Director</b>	<b>Jennifer Talarico</b>

We'd like to extend a sincere **“Thank You”** to...

**Routledge, Taylor & Francis** for their continued financial support of the MSS Annual Meeting.

### Cover Art:

Paul Punzo is a visual artist who works with linoleum block carvings, watercolors, silkscreen, spray paint, and india inks, creating one-of-a-kind pieces of art. Paul has shown work in galleries throughout Kansas, including Lawrence, Topeka, Kansas City, and Wichita, and has sold to collectors throughout the United States. The idea behind this image was to create a dialogue of issues, actions, and the collective human society, or simply “we.” Postcards are available on his Etsy shop @elgatoprinting and you can follow him on Instagram @elgatoprinting as well.